

# UBIFLUX COMPACT W200

## Heat recovery ventilation unit



### Product information

Ubiflux Compact W200 is a compact heat recovery ventilation unit delivering up to 200 m<sup>3</sup>/h. Designed for apartments, small homes and renovation projects, it fits easily into tight spaces such as kitchen cupboards or small storage rooms. The unit offers simple operation, an integrated summer bypass and is available in left- and right-hand versions. It can be expanded with CO<sub>2</sub>/RH demand control and accessories such as a preheater and advanced filters.

- Compact 200 m<sup>3</sup>/h unit fits standard cupboards and small service spaces
- Integrated summer bypass for straightforward comfort control
- Left or right duct versions for flexible installation
- Optional enthalpy exchanger (no condensate drain)
- Expandable with CO<sub>2</sub>/RH demand control, preheater and advanced filters

### Product dimensions

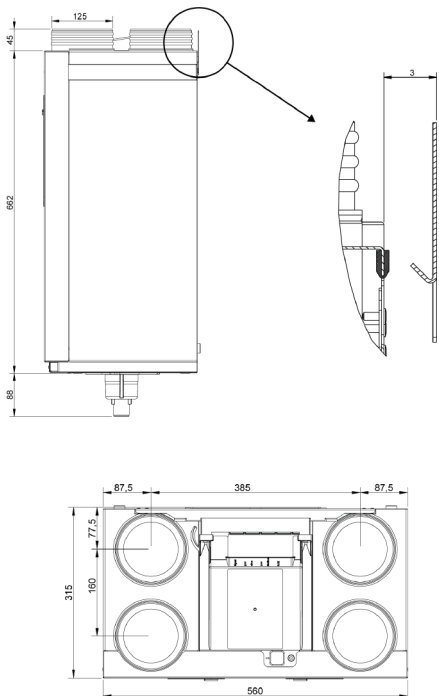

# UBIFLUX COMPACT W200

Heat recovery ventilation unit



## Technical specifications

Specifications											
Ubiflux Compact W200											
Supply voltage [V/Hz]	230 V / 50 Hz										
Dimensions (w x h x d) [mm]	560 x 660 x 315										
Duct diameter [mm]	125										
External diameter siphon outlet [mm]	32										
Weight [kg]	17										
Filter class	ISO Coarse 60%										
Fan setting	0	1	2	3	max						
Airflow m <sup>3</sup> /h (factory set values)	50	75	100	150	200						
Permissible resistance of duct system [Pa]	3	9	7	21	13	38	28	84	50	150	
Rated power [W]	8,5	9,2	11,0	12,8	17,0	20,7	39,6	50,2	77,5	100,4	
Rated current [A]	0,12	0,13	0,13	0,15	0,17	0,21	0,35	0,43	0,64	0,82	
Cos φ	0,310	0,316	0,372	0,383	0,425	0,437	0,496	0,507	0,528	0,535	
Max rated current [A]	1,5										
Permitted ambient conditions	Between +2°C and +40°C. RH <90% non condensing										
Storage and transport conditions	Between -20°C and +45°C. RH <90% non condensing										
Permitted air temperature through appliance	Between -20°C and +45°C										
Sound power											
Ventilation capacity [m <sup>3</sup> /h]					80	120	160	200			
Sound power level Lw(A)	Static pressure [Pa]				25	50	75	100			
	Casing radiation [dB(A)]				36,2	41,7	46,2	49,7			
	Duct 'From dwelling' [dB(A)]*				37,5	45,5	50,5	55,5			
	Duct 'To dwelling' [dB(A)]*				53	61,5	66,5	70,5			

\* Duct sound level including end correction. In practice the value may differ by 1dB(A) through measurement tolerances.

# UBIFLUX COMPACT W200

Heat recovery ventilation unit



Fan chart

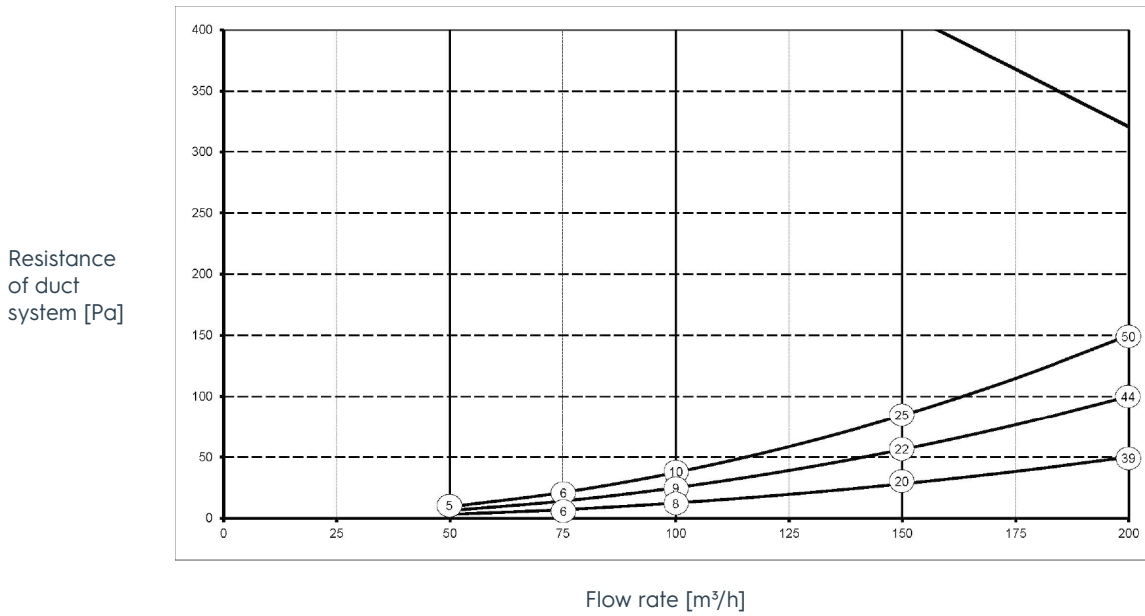

Note that the values circled in the graph are the power used (in Watt) per fan.

# UBIFLUX COMPACT W200

## Heat recovery ventilation unit

### Connections

The Ubiflux Compact W200 appliance is available in a left-hand and right-hand version.

#### Left-hand version:

- The “warm” connections supply air (1) and extract air (3) are on the left-hand side of the appliance.
- The condensate drain outlet is located at the right-hand side on the bottom of the appliance.

#### Right-hand version:

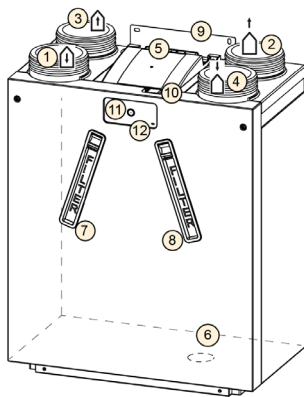

- The “warm” connections supply air (1) and extract air (3) are on the right-hand side of the appliance.
- The condensate drain outlet is located at the left-hand side on the bottom of the appliance.

Left-hand version

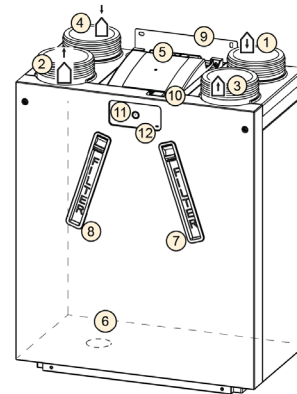

Right-hand version

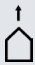

1. Supply air		7. Exhaust air filter
2. Exhaust air		8. Supply air filter
3. Extract air		9. Mounting bracket
4. Outdoor air		10. USB and Service Tool connection
5. Electrical connections PCB		11. Push button
6. Siphon connection		12. Status LED

# UBIFLUX COMPACT W200

Heat recovery ventilation unit

## Overview internal parts

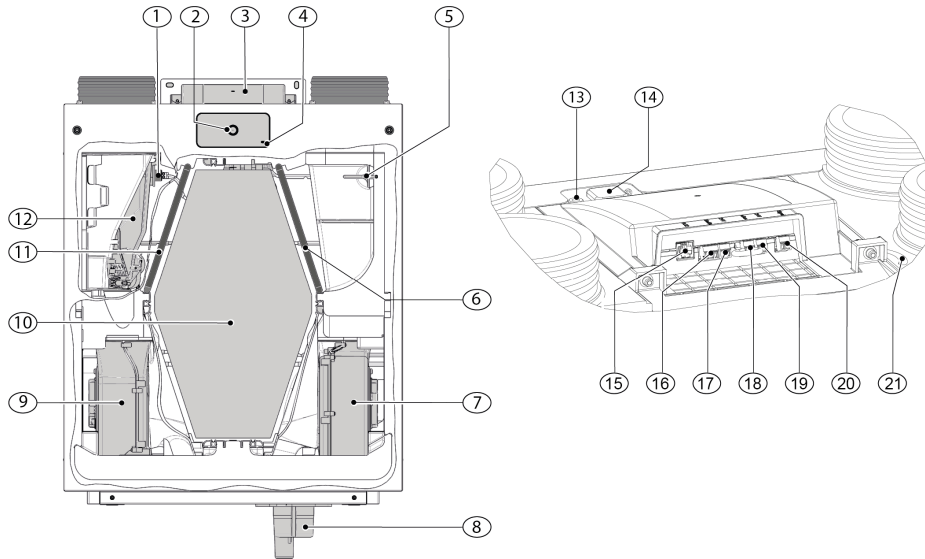

The appliance shown above is a left-hand version: in a right-hand version all the internal parts are mirrored.

1. Extract air temperature sensor (NTC2)	12. Bypass valve incl. motor
2. Push button	13. Service Tool connection
3. PCB location	14. USB connection
4. Status LED	15. RJ12 connector (X14/black)
5. Outdoor air temperature sensor (NTC1)	16. ModBus connection (X15/red)
6. Supply air filter	17. 24V connection (X16/black)
7. Exhaust fan	18. eBus connection (X17/green)
8. Siphon	19. 24V connection (X18/black)
9. Supply fan	20. Relay output (X19/blue)
10. Heat exchanger	21. 230V power supply cable
11. Exhaust air filter	